



48" Professional Side-by-Side

Born of 100% steel (and a good bit of bravado), model 648PRO is a true masterpiece of preservation. Its sculpted metal, dual refrigeration with three evaporators and advanced controls marry performance and design in a bold new way for home refrigeration. So it not only keeps foods magnificently fresh, it brings the whole kitchen tastefully up to date. Model 648PRO can be built-in or used in a free-standing application.



Model 648PRO shown in a free-standing application.

FEATURES

- Handles coordinate with Wolf ranges.
- Stainless steel interior and exterior.
- Dual refrigeration system with two compressors and three evaporators keeps food fresher longer.
- Microprocessor and interior touch control panel with exterior digital temperature display.
- Ceiling lighting in both upper cabinets with LED side lighting in refrigerator.
- Adjustable spill-proof glass shelves.
- Slide-out stainless steel bins fit neatly under refrigerator glass shelves.
- Touch-and-glide crisper drawer with tight-sealing clear cover.
- Interior drawer dividers can be used in either refrigerator drawer.
- Precision-built auto-close door hinges.
- Easy-access flip-up grille.
- Automatic ice maker with advanced water filtration system.

INTERIOR FEATURES

- **Refrigerator (door and two drawers)**
 - 3 Adjustable Glass Shelves
 - 1 Stationary Glass Shelf
 - 2 Adjustable Stainless Steel Slide-Out Bins
 - 1 Glass Crisper Lid
 - Interchangeable Drawer Dividers
- **Freezer (door and two drawers)**
 - Automatic Ice Maker
 - Water Filtration Filter
 - 3 Adjustable Stainless Steel Shelves
 - 1 Stationary Stainless Steel Shelf
 - Stainless Steel Ice Bucket
- Exterior Temperature Display
- Auto-Close Advanced Hinge System

ACCESSORIES

- Stainless steel side panels and top for freestanding application.
- Stainless steel side panel.
- Stainless steel front and side kickplates.
- Slide-out stainless steel refrigerator bins.
- Refrigerator drawer dividers.
- Replacement water filter.
- 90° door stop.

Accessories are available through your Sub-Zero dealer. For local dealer information, visit the find a showroom section of our website, subzero.com.



Slide-out bins.



Glass crisper lid.





48" Professional Side-by-Side

OVERALL DIMENSIONS

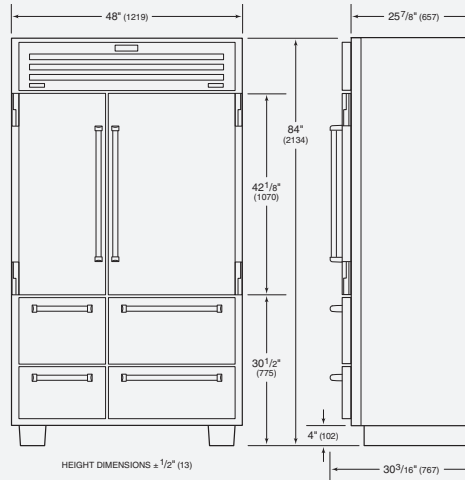

Unit dimensions may vary by $\pm 1/8"$.

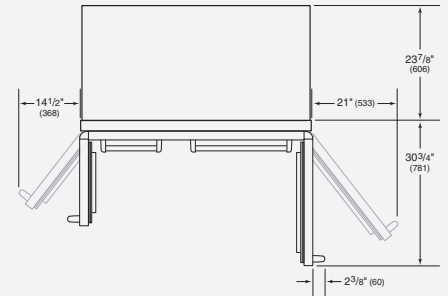

Dimensions in parentheses are in millimeters unless otherwise specified.

SPECIFICATIONS

Overall Width	48"
Overall Height	84"
Overall Depth	24"
Door Swing Clearance	30 ³ / ₄ "
Refrigerator Capacity	18.4 cu ft
Freezer Capacity	11.7 cu ft
Finished Opening	
(standard)	47 ¹ / ₂ " W x 83 ³ / ₄ " H x 24" D
(flush)	48" W x 84 ¹ / ₈ " H x 26" D
Minimum Height Required	83 ¹ / ₂ "
Electrical Requirements	115 V AC, 60 Hz 15 amp dedicated circuit
Plumbing Requirements	1/4" OD copper, braided stainless steel or PEX tubing 35–120 psi
Shipping Weight	860 lbs

INSTALLATION NOTES

Model 648PRO can be used free-standing or installed as a standard or flush built-in application. For standard built-in installations, the face frame of the unit will extend 2" beyond cabinetry. In flush built-in installations, the front of the face frame will be flush with surrounding cabinetry.

Complete installation specifications, including panel sizes, can be found on our website, subzero.com/specs.

INSTALLATION SPECIFICATIONS

Standard and Flush Built-In

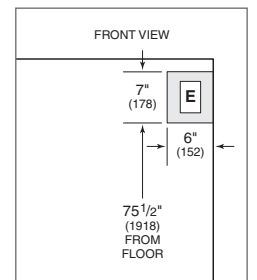
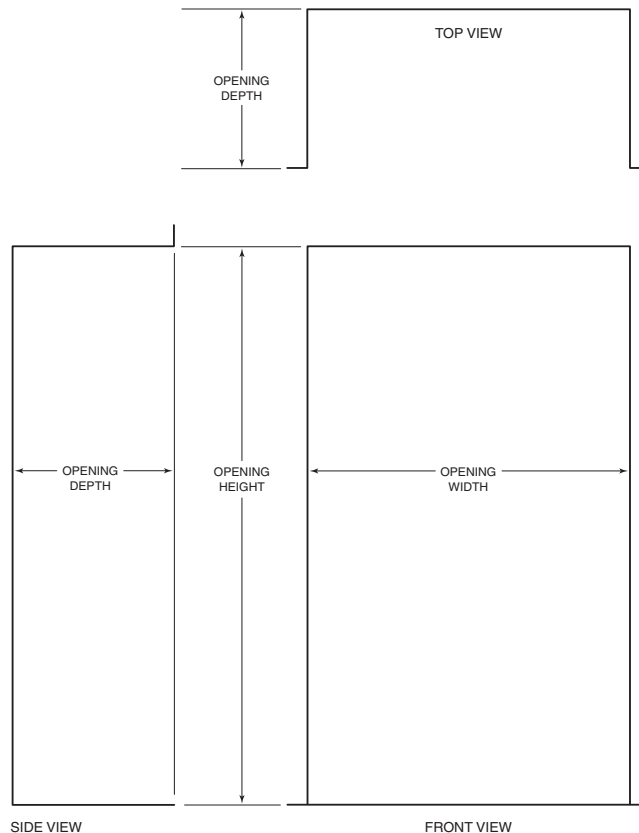

Location of Electrical Supply

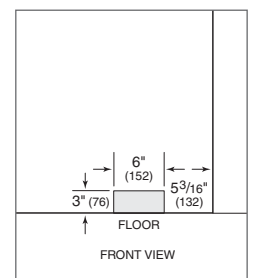

Location of Water Supply

Opening Dimensions	Standard	Flush
Opening Width	47 ¹ / ₂ "	48"
Opening Height	83 ³ / ₄ "	84 ¹ / ₈ "
Opening Depth	24"	26"



60" Gas Ranges

Wolf has perfected the form, function and sheer durability of our gas ranges. Wolf gas ranges offer standard features such as an infrared oven broiler, convection baking, dual-stacked sealed surface burners and our signature large red control knobs. Optional infrared charbroiler, infrared griddle and French top give you the freedom to customize your gas range. Wolf gas ranges are available in natural or LP gas.



Model GR606F shown.
Also shown is model WWD30 warming drawer.



Model GR606DG



Model GR606F



Model GR606CG

FEATURES

- Heavy-duty stainless steel exterior with island trim.
- Dual-stacked, sealed burners for precise control and easy cleanup.
- Flame recognition and automatic reignition for safety and ease of use.
- Signature red control knobs with infinite control.
- Stainless steel bezels surround control knobs.
- Porcelain-coated, cast iron continuous burner grates.
- Top configurations including infrared charbroiler, infrared griddle and French top with stainless steel covers.
- Large-capacity gas convection ovens with three adjustable oven racks.
- Infrared broiler with ultrafast pre-heating.
- Halogen lit, porcelain oven interiors with window in doors.
- Adjustable stainless steel legs in front and rear casters.
- Wolf exclusive spring and damper door hinge system.

SURFACE FEATURES

Model	GR606DG	GR606F	GR606CG
Surface Burners 15,000 Btu high / 950 Btu simmer	5	5	5
Surface Burner 9,200 Btu high / 325 Btu simmer	1	1	1
Infrared Charbroiler – 16,000 Btu			•
Infrared Griddle – 15,000 Btu			•
Double Griddle – 15,000 Btu (2)	•		
French Top – 15,000 Btu		•	

Model numbers are for natural gas ranges, add (-LP) to the model number for LP gas.

ACCESSORIES

- 5" and 10" stainless steel risers—20" riser with shelf.
- Red, black or stainless steel control knobs.
- Brass and chrome bezels.
- Cast iron S-grates and wok grate.
- Hardwood cutting board (griddle models only).
- Additional oven racks.
- Full-extension easy glide rack.
- Bake stone kit.
- Griddle cleaning kit.
- Front leg covers.
- High altitude conversion kit.

Accessories are available through your authorized Wolf dealer. For local dealer information, visit the find a showroom section of our website, wolfappliance.com.



This appliance is certified by Star-K to meet strict religious regulations in conjunction with specific instructions found on www.star-k.org.



60" Gas Ranges

OVERALL DIMENSIONS

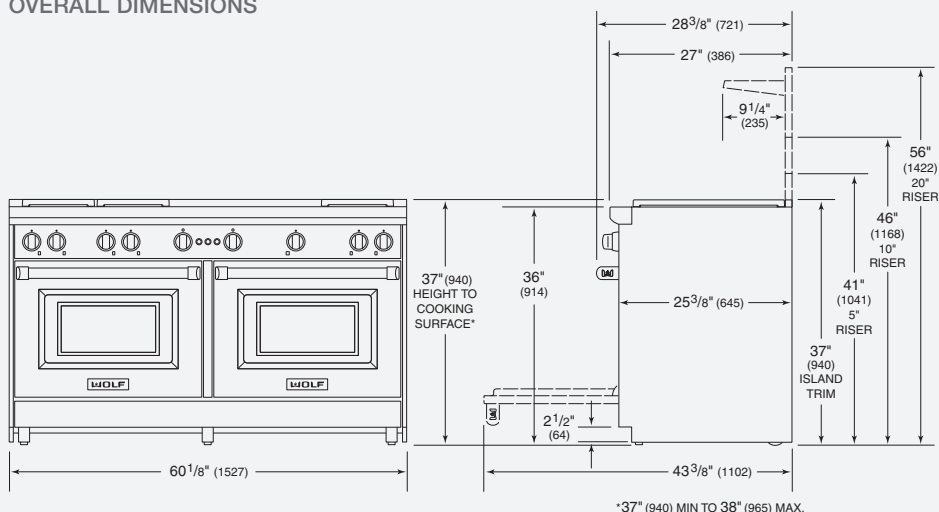

Unit dimensions may vary by $\pm 1/8$ ".

SPECIFICATIONS

Exterior Finish	Stainless Steel
Overall Width	60 $\frac{1}{8}$ "
Overall Height (to cooking surface)	37"
Overall Depth	28 $\frac{3}{8}$ "
Oven Interior Capacity (per oven)	4.4 cu ft
Oven Interior Dimensions (per oven)	24" W x 18 $\frac{5}{8}$ " H x 17" D
Opening Width	60 $\frac{1}{4}$ "
Opening Height (to countertop)	36"
Opening Depth	24"
Electrical Requirements	110/120 V AC 50/60 Hz, 15 amp circuit
Shipping Weight	875–950 lbs

INSTALLATION SPECIFICATIONS

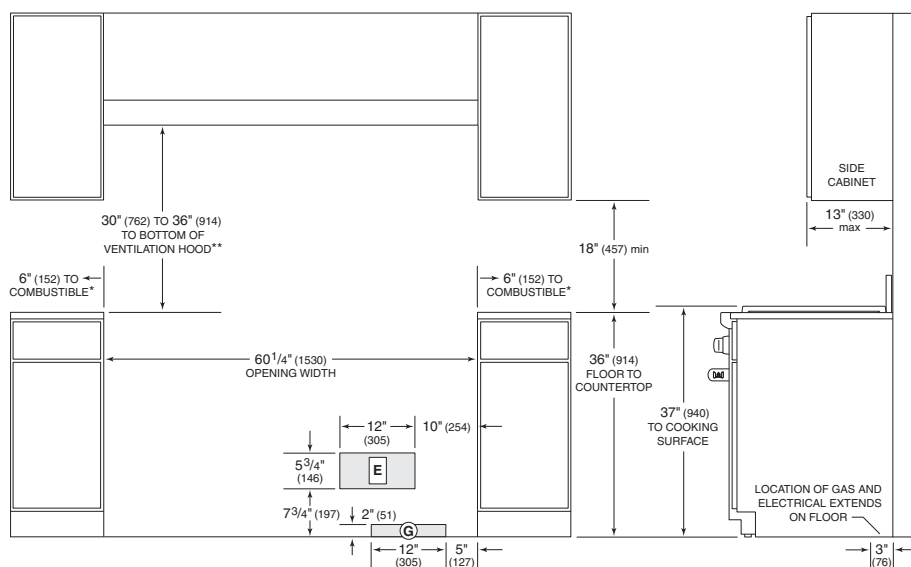

*Minimum clearance from rough opening to combustible materials up to 18" (457) above countertop.

**44" (1118) minimum clearance from countertop to combustible materials without ventilation hood.

NOTE: For island installations, 12" (305) minimum clearance from back of range to combustible rear wall above countertop.

INSTALLATION NOTES

- A riser is required for installations against a combustible surface.
- A Wolf pro wall, chimney, island ventilation hood or hood liner is recommended.

Dimensions in parentheses are in millimeters unless otherwise specified.



Cooktop Low-Profile Wall Hoods

Behind the contemporary lines of the Wolf cooktop low-profile hoods, there's a lot of hard-nosed functional thinking. Brilliant halogen lighting illuminates your cooking surface. Powerful multi-speed blowers whisk away smoke and odors. Available in three widths, low-profile wall hoods are stainless steel with a black glass front panel and are recommended for use with Wolf induction, electric and gas cooktops and integrated modules.



FEATURES

- Heavy-duty stainless steel construction.
- Telescopic flue fits 8' to 9' ceilings.
- Front-mounted electronic controls with digital indicator and four-speed blower control.
- Sealed halogen lighting with three settings.
- Internal, in-line and remote blower options.
- Internal blower (I) models can be used in a non-ducted application using an accessory charcoal recirculating filter.
- Heat sentry feature automatically turns unit on when heat is sensed and automatically adjusts blower speed.
- Delay-off mode automatically turns unit off.
- Stainless steel filter cover with dishwasher-safe aluminum mesh filter.
- Filter clean indicator lets you know when the filter needs cleaning.
- Transition with backdraft damper included.

MODEL OPTIONS

Model	CTEWH30I	CTEWH36	CTEWH36I	CTEWH45	CTEWH45I
Overall Width	30"	36"	36"	45"	45"
500 CFM Internal Blower Included	•		•		•

BLOWER OPTIONS

	INTERNAL				IN-LINE		REMOTE			
CFM	500	600	900	1200	600	1100	600	900	1200	1500
CTEWH36 CTEWH45					•		•			

ACCESSORIES

- In-line and remote blowers for CTEWH36 and CTEWH45 (refer to chart above).
- 30" high stainless steel wall shield in 30" and 36" widths (not available in 45" width).
- Recirculating kit for non-ducted installations.
- Replacement charcoal filters.

Accessories are available through your authorized Wolf dealer. For local dealer information, visit the find a showroom section of our website, wolfappliance.com.



Model CTEWH36
Cooktop Low-Profile Wall Hood

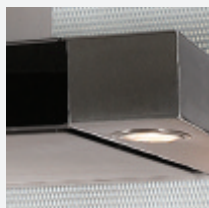

Sealed halogen lighting.



Electronic controls.



Cooktop Low-Profile Wall Hoods

OVERALL DIMENSIONS

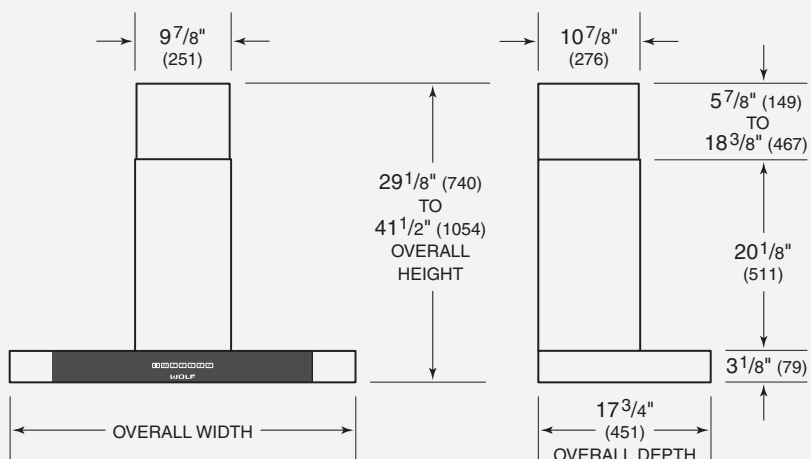

Unit dimensions may vary by $\pm 1/8$ ".

SPECIFICATIONS

Exterior Finish	Stainless Steel
Overall Widths	30", 36" and 45"
Height (excluding chimney)	3 1/8"
Min Height (including chimney)	29 1/8"
Max Height (full extension)	41 1/2"
Overall Depth	17 3/4"
Bottom of Hood to Countertop	24" to 30"
Discharge	Vertical
Duct Size	6" Round
Electrical Requirements	110/120 V AC 60 Hz, 15 amp dedicated circuit
Shipping Weight	53–62 lbs

INSTALLATION NOTES

(I) models include a 500 CFM internal blower. An in-line or remote blower is required for models CTEWH36 and CTEWH45. For blower recommendations, visit our website, wolfappliance.com.

Cooktop low-profile hoods are recommended for use with Wolf induction, electric and gas cooktops and integrated modules. For Wolf ranges and rangetops, a pro ventilation hood is recommended.

Complete installation specifications can be found on our website, wolfappliance.com.

INSTALLATION SPECIFICATIONS

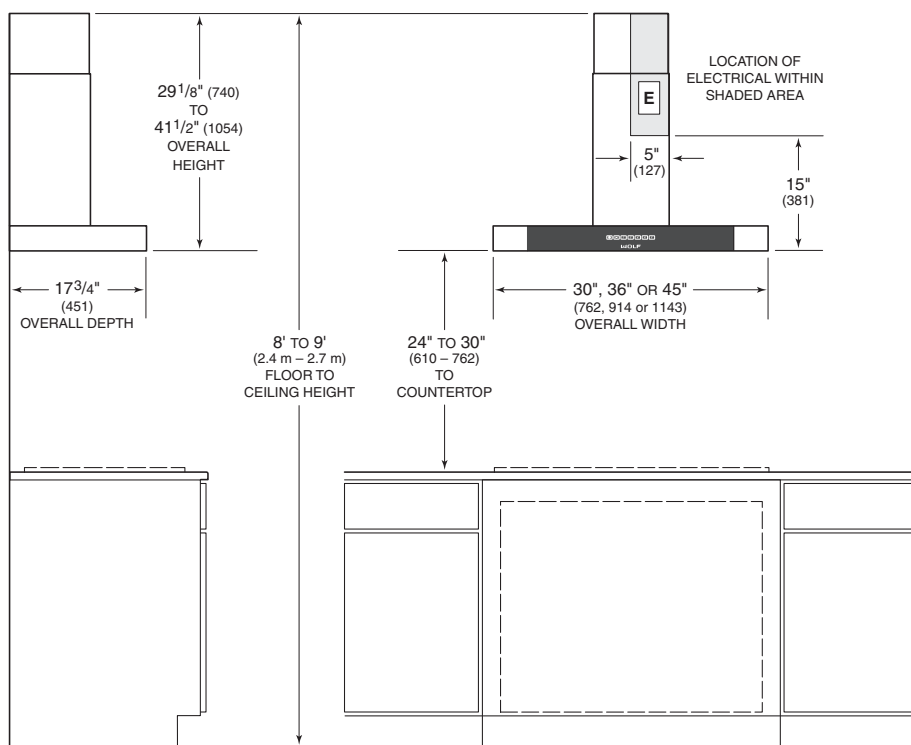

Dimensions in parentheses are in millimeters unless otherwise specified.



30" Warming Drawer

The superior air control of the Wolf warming drawer helps keep moist foods moist and crisp foods crisp. Stainless steel and black glass drawer fronts match the look of our built-in ovens and ranges, and the integrated drawer front allows for a custom wood panel. Electronic controls are hidden so the unit integrates with surrounding cabinetry.



Model WWD30 shown with L series drawer front.

FEATURES

- Can be installed in a standard or flush inset application.
- Approved for warming towels.
- Crafted of heavy-duty stainless steel.
- Hidden electronic touch controls for sleek appearance.
- Temperature control range of 80°F to 200°F.
- Four preset temperatures: high 200°F, medium 160°F, low 120°F and proof 85°F.
- Programmable automatic shutoff up to four hours.
- Fan assist for even heat distribution.
- Fast preheat times.
- Rack for stacking food.
- Three ball-bearing drawer glides for smooth, full extension.
- Removable stainless steel drawer for easy cleaning.

DRAWER FRONT OPTIONS

DRAWER FRONT OPTIONS	HANDLE
L Series	Tubular
E Series Framed and Unframed	Tubular
E Series Black Glass Unframed	Tubular
E Series 1" and 2" Thick	Pro
E Series 2" Thick /36" Wide	Pro
Integrated	Custom

Model WWD30 is sold as a base unit only. A drawer front panel is required. Panels are available through your authorized Wolf dealer. Stainless steel drawer front panels include a handle to match built-in ovens and ranges. Integrated drawer front allows for a custom wood panel and handle hardware.

ACCESSORIES

- Stainless steel drawer fronts to match style of Wolf ovens and ranges.
- 2" thick stainless steel drawer fronts for installation below sealed burner rangetop.
- Integrated drawer front for custom wood applications—panel can exceed 30" width.
- Six-piece container set with lids.
- Stainless steel tubular and pro handles.

Accessories are available through your authorized Wolf dealer. For local dealer information, visit the find a showroom section of our website, wolfappliance.com.

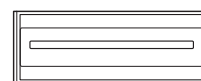

L Series Drawer Front



E Series Drawer Front with Tubular Handle



E Series Drawer Front with Pro Handle



Integrated Drawer Front



Accessory container set.



This appliance is certified by Star-K to meet strict religious regulations in conjunction with specific instructions found on www.star-k.org.



30" Warming Drawer

OVERALL DIMENSIONS

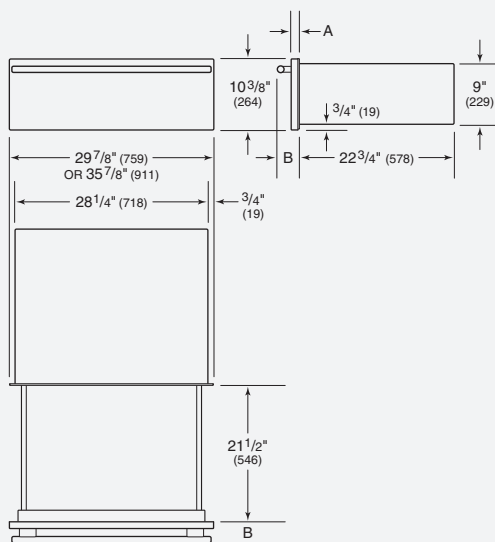

Dimensions may vary by $\pm 1/8$ ".

STAINLESS STEEL DRAWER FRONT

L SERIES	A	B
Tubular Handle	7/8"	3 1/2"

E SERIES	A	B
Tubular Handle	1 1/8"	3 1/2"
Pro Handle	1 1/8"	3 1/2"
Pro Handle (2" thick)	2 1/8"	4 1/2"

BLACK GLASS DRAWER FRONT

E SERIES	A	B
Tubular Handle	1 1/8"	3 1/2"

INTEGRATED DRAWER FRONT

CUSTOM PANEL	W	H	D
Typical	29 7/8"	10 3/8"	3/4"

SPECIFICATIONS

Interior Capacity	1.6 cu ft
Interior Dimensions	25" W x 6" H x 18" D
Integrated Panel Thickness (min)	5/8"
Integrated Panel Weight (max)	25 lbs
Heating Element	850 W
Electrical Requirements	120 V AC, 60 Hz 15 or 20 amp circuit
Power Cord	3' cord with grounded plug
Shipping Weight	100 lbs

INSTALLATION SPECIFICATIONS

Standard Installation – L Series, E Series and Integrated Drawer Front

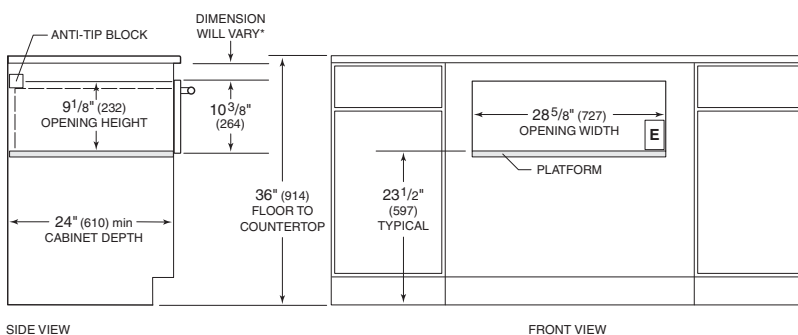

*Dimension must accommodate height of anti-tip block and drawer face overlap.

NOTE: Location of electrical supply within opening may require additional cabinet depth. Dashed line represents profile of unit.

Flush Inset Installation – E Series and Integrated Drawer Front

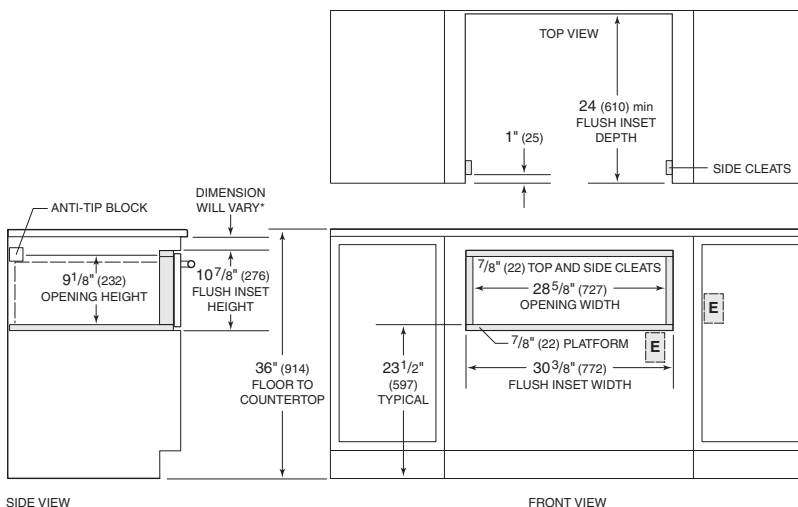

*Dimension must accommodate height of anti-tip block and drawer face overlap.

NOTE: Dimensions provided allow for 1/4" (6) for proper air flow. Location of electrical supply within opening may require additional cabinet depth. Dashed line represents profile of unit.

Dimensions in parentheses are in millimeters unless otherwise specified.

Futura Series

Fully Integrated Dishwashers

CLASSIC G 4286 SCVi, G 4286 SC SF
CRYSTAL G 5285 SCVi, G 5285 SC SF
DIMENSION G 5675 SCVi, G 5675 SC SF
DIAMOND G 5975 SCVi, G 5975 SC SF



Futura Series Dishwashers

Model Overview



		CLASSIC	CRYSTAL	DIMENSION	DIMENSION SLIMLINE	DIAMOND	PROFI LINE
Baskets	FlexiCare	•					
	FlexiCare Plus		•		•		
	FlexiCare Premium			•			
	FlexiCare Deluxe					•	•
Cutlery	Cutlery basket	•	•		•		
	Cutlery tray	•	•		•		
	3D cutlery tray			•		•	•
Convenience	AutoClose					•	•
	BrilliantLight					•	•
	Delay Start	•	•	•		•	•
	RemoteVision™					•	
	ComfortClose	•	•	•		•	•
	Perfect GlassCare		•	•	•	•	•
	Water softener		•	•	•	•	•
	ADA compliant*	•*		•*	•		
	Q Acoustic ratings	Q1	Q2	Q4	Q3	Q5	Q1
Sensors	AutoSensor	•	•	•	•	•	
	SensorDry			•		•	
	Automatic Load-Size Sensor					•	
Finishes	Pre-finished (Black or White)	•	•				
	Pre-finished (Clean Touch Steel™)	•	•	•			
	Integrated - I (Clean Touch Steel™)			•	•	•	
	Fully Integrated - Vi (Custom Panel)	•		•	•	•	•
	Fully Integrated - SC SF (Clean Touch Steel™)	•	•	•		•	
Programs	Normal	•	•	•	•	•	
	Express		•		•	•	
	Rinse & Hold	•	•	•	•	•	
	SaniWash	•	•	•	•	•	
	Pots & Pans	•	•	•	•	•	•
	Economy	•					
	China & Crystal		•	•	•	•	•
	Turbo Mode	•	•	•		•	
	Intensive Mode			•		•	
Diamond Programs	ExtraQuiet			•		•	
	Heavy Soil					•	
	SensorWash					•	
	Light					•	
	Energy Saver					•	
	Plastics					•	•
	Starch/Cheese					•	
	Tall Items					•	
	Glass - No Rinse Aid (Warm)					•	
	Glass - No Rinse Aid (Cold)					•	
Profiline Programs	ProSpeed 23 minute cycle						•
	Universal						•
	Sanitize						•
	Beer Glasses						•
Drying	CleanAir™	•	•	•	•	•	•
	Advanced CleanAir™					•	•
	AutoOpen™ Drying			•		•	•

* Classic G 4281 SCVi and Dimension G 5670 SCVi are ADA compliant

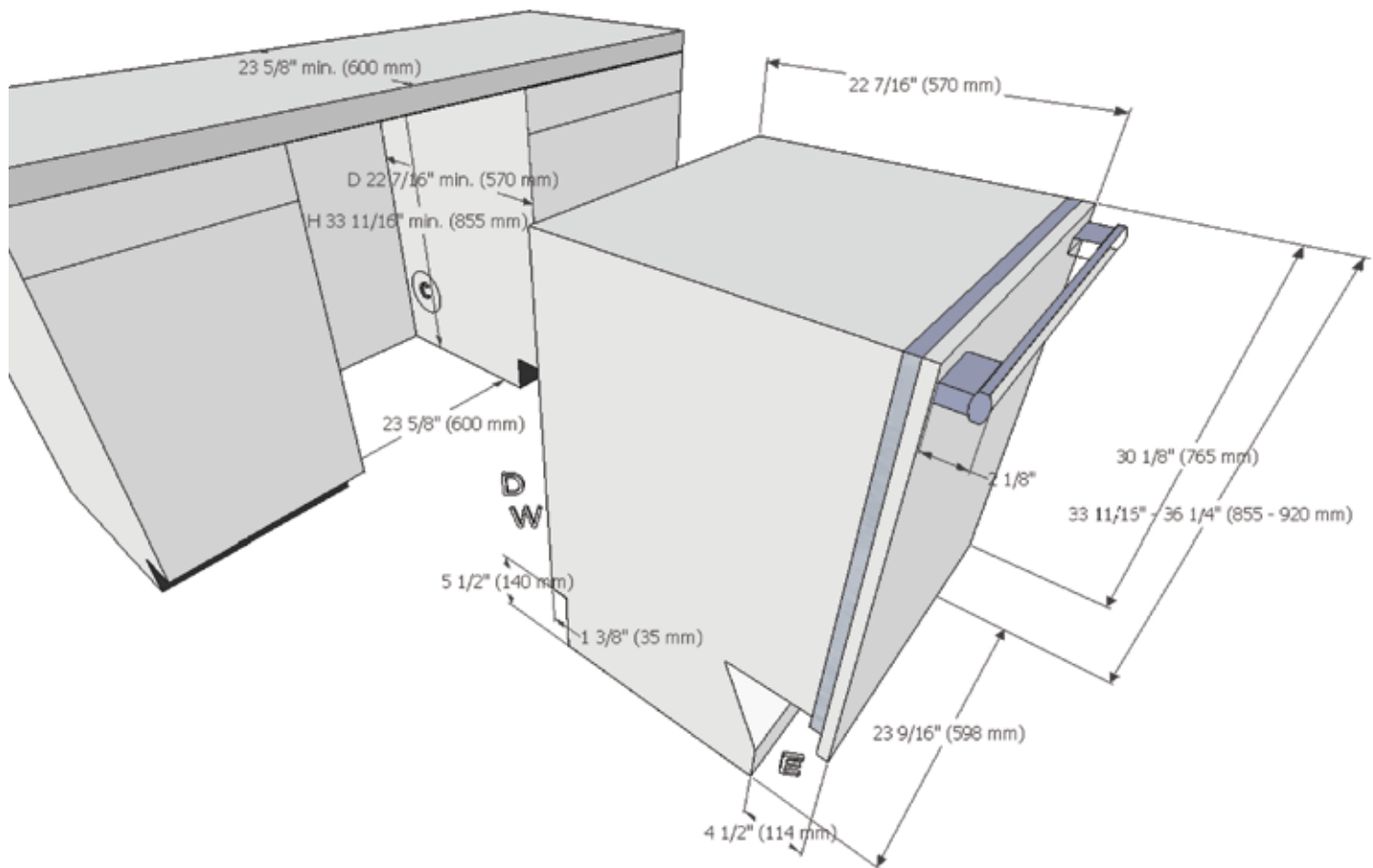

Location Codes

C - Cutout 1 3/8" x 1 3/4" (34 mm x 35 mm) for water, drain and electric pass-through.

Adjust according to water and drain location.

D - 5 foot (1.5 meter) flexible drain hose connects lower center rear.

E - 5 foot (1.5 meter)– 120 Volt – 15 Amp 3-wire molded plug power supply connects front terminal or can be hardwired.

W - 5 foot flexible water intake hose with a 3/8" compression fitting nut connects lower center rear.

Notes

All installations must be done in accordance with local codes.

Drawing is not to scale

Specification Sheets OJS 11012011

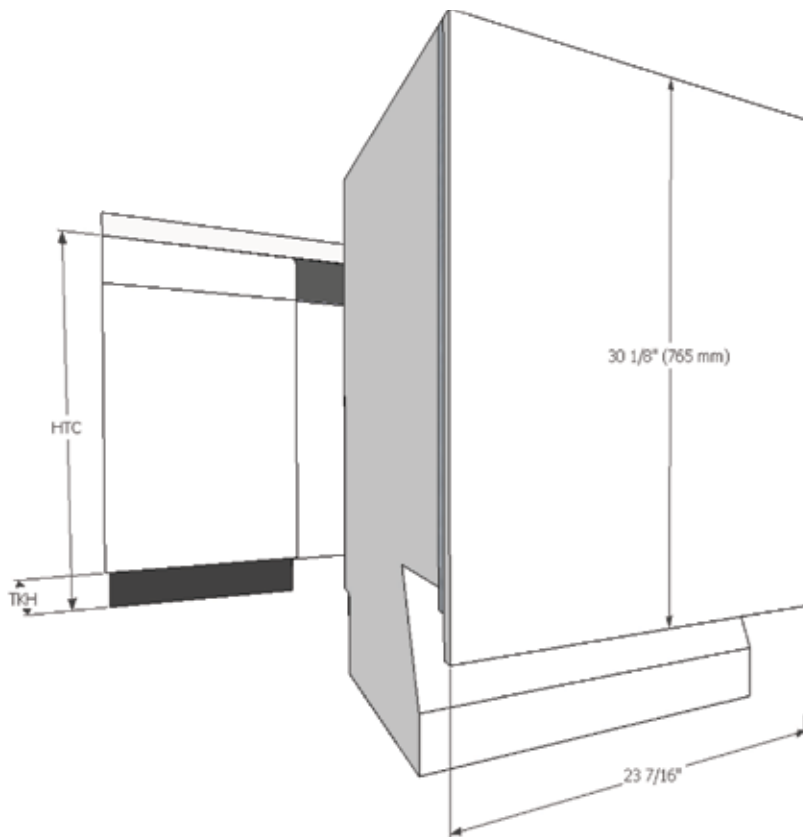

Panel Prefinished

Width: 23 7/16" (598 mm)

Thickness: 3/4" (19 mm)

Height: 30 1/8" (765 mm)

Calculating the toe kick height

$$30 \frac{1}{8}" - \text{HTC} = \text{TKH}$$

HTC = Height to the underside of countertop

TKH = Toe kick height (Panel height is configured for a 4" toe kick)

Note: Control panel is along the top edge of the unit. It is not visible when the unit is closed. A handle **MUST** be installed on the front panel in order to open the unit.

GFVI Installations

Miele offers pre-fabricated stainless steel panels for all fully integrated units. These panels are designed for various toe-kick heights and offer a choice of handle options.

Drawing is not to scale

Specification Sheets OJS 11012011

		Height to underside of countertop									
		33 3/4	34	34 1/4	34 1/2	34 3/4	35	35 1/4	35 1/2	35 3/4	36
Toe Kick Height	2 1/2										
	3										
	3 1/2										
	4										
	4 1/2										
	5										
	5 1/2										
	6										
	6 1/2										
	7										
	7 1/2										
	8										
	8 1/2										
</											



24" Undercounter Beverage Center

Sub-Zero undercounter units simplify life at home by bringing refrigeration anywhere it's needed. Fresh greens in the kitchen island. Soda and snacks in the media room. Chilled mineral water in the master suite. Model UC-24BG has a full-view glass door and is available in the overlay or stainless steel design. It also features two wine storage shelves that will hold up to 16 (750 ml) bottles.



Model UC-24BG/O overlay shown. Also shown is model 424G/O wine storage.

FEATURES

- Full-view, UV-resistant glass door—high altitude glass available.
- Easy-access, touch control panel with LCD display.
- Temperature range from 34°F to 45°F.
- Bright interior lighting.
- Roller-glide wine shelves with natural cherrywood facing have three-quarter extension for easy access.
- Adjustable, spill-proof glass shelf.
- Clear utility bin for storage of smaller items.

MODEL OPTIONS

	UC-24BG/O	UC-24BG/S/TH	UC-24BG/S/PH
Design/Finish	Overlay	Stainless Steel	Stainless Steel
Handle	*	Tubular	Pro

*Handle not included to allow for design flexibility.

INTERIOR FEATURES

- **Beverage Center**
 - 2 Wine Storage Shelves
 - Adjustable Glass Shelf
 - Clear Utility Bin
 - Full-View Glass Door

ACCESSORIES

- Stainless steel tubular and pro handles.
- Door lock.

Accessories are available through your Sub-Zero dealer. For local dealer information, visit the find a showroom section of our website, subzero.com.



Clear utility bin.



Wine storage shelves.





24" Undercounter Beverage Center

OVERALL DIMENSIONS

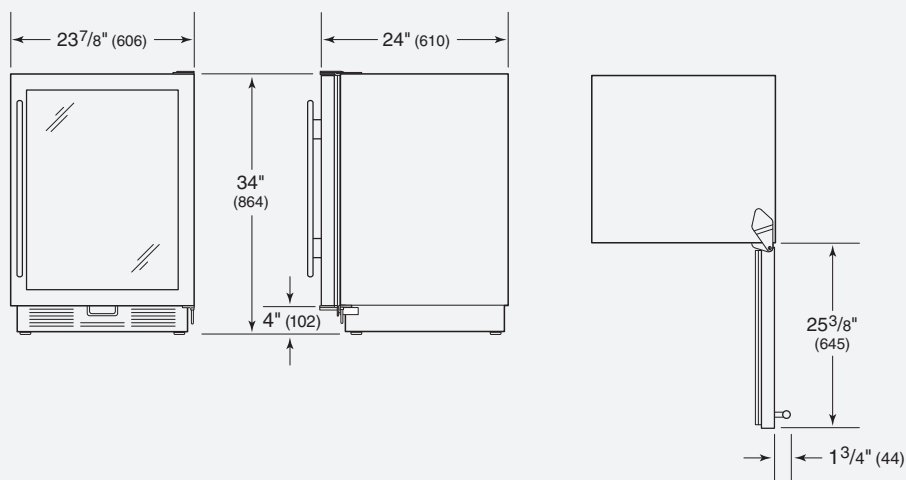

Unit dimensions may vary by $\pm 1/8"$.

SPECIFICATIONS

Overall Width	23 7/8"
Overall Height	34"
Overall Depth	24"
Door Clearance	25 3/8"
Refrigerator Capacity	5.7 cu ft
Wine Storage Capacity	up to 16 Bottles (750 ml)
Opening Width	24"
Opening Height	34 1/2"
Opening Depth	24"
Electrical Requirements	115 V AC, 60 Hz 15 amp dedicated circuit
Shipping Weight	135 lbs

INSTALLATION SPECIFICATIONS

Opening Dimensions

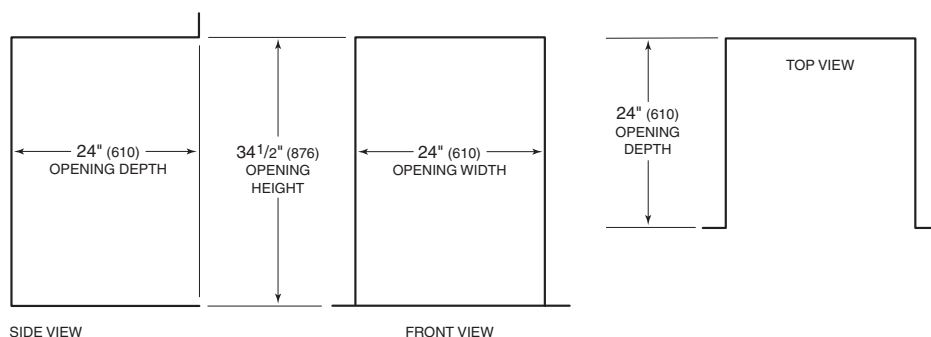

Location of Electrical Supply

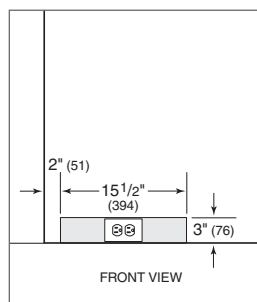

INSTALLATION NOTES

Undercounter model UC-24BG is available in your choice of the overlay or stainless steel design application. A high altitude glass door unit may be special ordered for installations at or above 5,000'.

Complete installation specifications, including panel sizes, can be found on our website, subzero.com/specs.

Dimensions in parentheses are in millimeters unless otherwise specified.